

Designed for Automation

Compact Precision Weighing



High resolution

Readability of 0.01 mg ensures a high level of control and quality in your process.



Compact design

Fully integrated electronics allow easy integration. The mounting holes and weighing pan position match other WKC family products and allow for easy upgrades of existing machines.



Robust

Stainless steel housing, shielded cable and liquid ingress protection help to prevent damage, allowing for the highest uptime and best ROI.



Easy adjustment

The internal test weight enables traceable consistency. Verify your process automatically with simplified internal calibration.



WKC205C

Precision Weigh Modules

WKC205C is tailored for automated dispensing and testing applications where robust and cost-effective solutions for on-board weighing with increased resolutions are required.

The WKC product family shares the same mounting holes, weighing pan location and M12 cable to allow for easy upgrades.

Model specific weighing data

Type information	WKC205C
Nominal capacity (nominal load)	200 g
Maximum capacity	220 g
Maximum preload ^{M1)}	20 g
Maximum preload for internal adjustment	50 g
Readability	0.01 mg
Internal adjustment	✓
Limit values ^{M2)}	
Repeatability (σ) (nominal load) \leq ^{M3)}	0.03 mg
Linearity deviation \leq	0.15 mg
Eccentric load deviation (test load) \leq	0.15 mg (100 g)
Sensitivity temperature drift \leq ^{M4)}	0.3 mg/°C
Typical values ^{M5)}	
Settling time, nominal \leq ^{M6)}	5 s
Repeatability, low load (σ) (Test load) \leq ^{M3)}	0.015 mg (50 g)
Settling time, fast \leq ^{M7)}	2.4 s
Ambient conditions	
Compensated temperature range ^{M8)}	10 °C to 30 °C
Operating temperature range	5 °C to 40 °C
Storage temperature range	-20 °C to 70 °C
Relative air humidity range ^{M8)}	20% to 80%
Warm-up time after power-on ^{M8)}	60 minutes

^{M1)} Maximum preload on top of adapter weighing pan to maintain maximum capacity

^{M2)} Applicable for stationary conditions within compensated temperature and relative air humidity range

^{M3)} σ = standard deviation (68 % of weighing results within $\pm 1\sigma$)

^{M4)} Weighing tests according to OIML R76 A.5.3 at stationary conditions

^{M5)} Applicable for stable environmental conditions and optimal filter settings

^{M6)} Time until weight value is repeatable (measured at nominal load)

^{M7)} Time until weight signal is within ± 2 x readability of end value (measured at 1/4 nominal load)

^{M8)} Condition to meet the specified limit values

General data

Electrical connection	
Power supply	12 – 24 V DC
Electrical connection	M12, 12 pins, A-coded, male
Communication interface	RS232, full-duplex, 2.4 to 38.4 kBaud RS422 full-duplex, 2.4 to 38.4 kBaud
Maximum weight update rate	92 values/s
IP protection	
Module during weighing	IP42
Materials	
Weighing pan/platform	Stainless steel (1.4307 / 304L)
Weigh module housing	Stainless steel (1.4307 / 304L)
Cable	PUR-PVC
Seals	NBR

Drawings (mm)

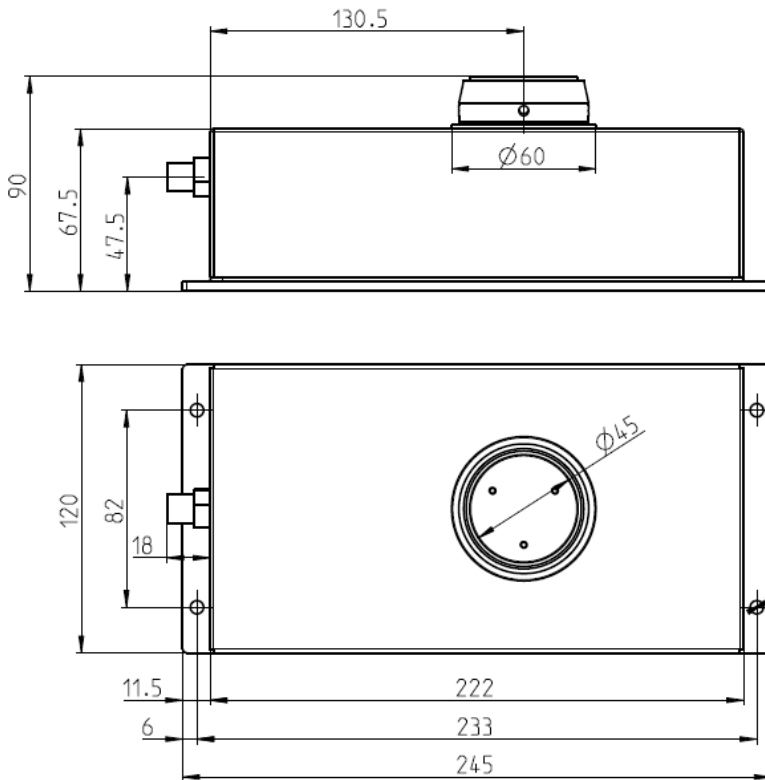

Adapter Weighing Pan Dimensions

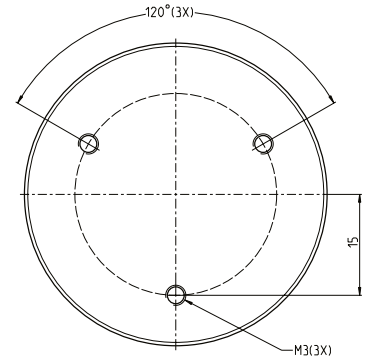

Typical configurations

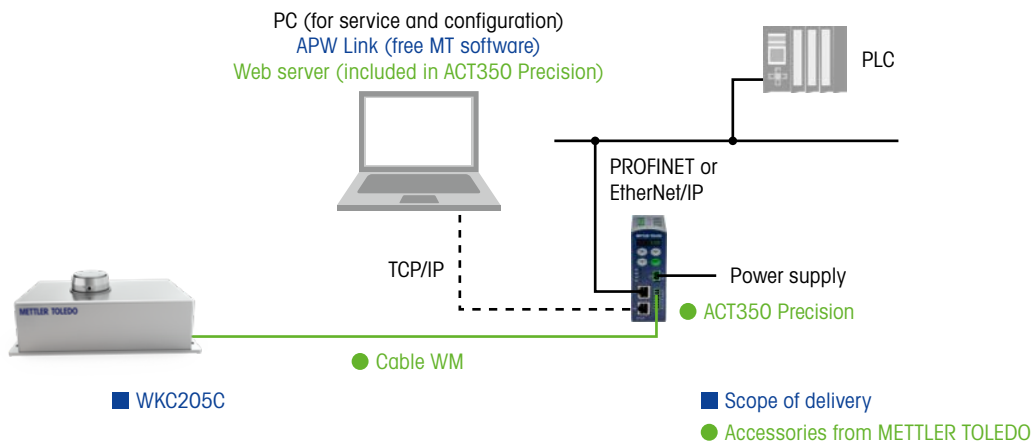

Automation network configuration



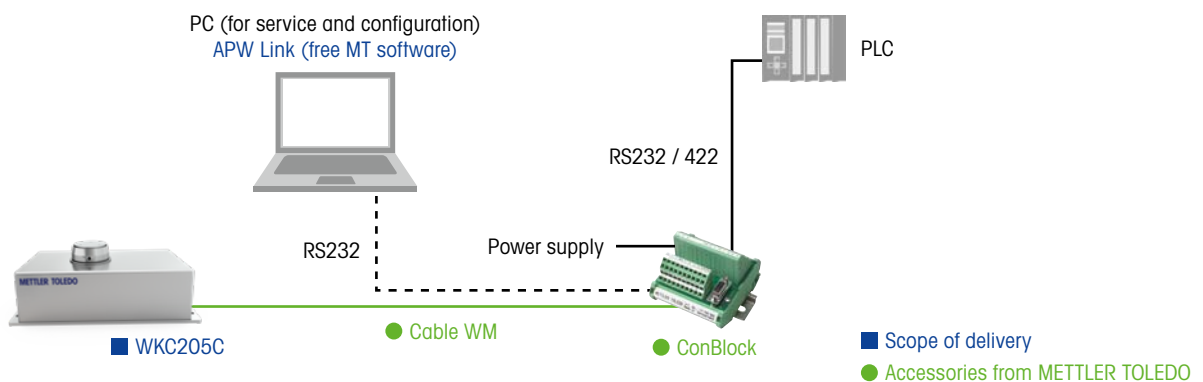







Serial interface configuration



Scope of delivery

Item	Description	Item number	Picture
Weigh module			
Adapter weighing pan	Adapter weighing pan with threaded holes	305 557 91	
Wind ring with holes	Wind ring with holes for liquid overflow protection	305 557 90	
Protection cap	Cap to protect the load cell during transportation		
User manual			
Production certificate			
CE Declaration of conformity			

Accessories

Item	Description	Item number	Picture
Cable WM	12p 1.5 m (M12f 90° DN – open leads)	302 958 19	
Cable WM	12p 5.0 m (M12f 90° DN – open leads)	302 958 21	
Cable WM	12p 3.0 m (M12f 180° – open leads)	305 248 60	
Cable WM	12p 0.3 m (M12f 90° DN – M12m 180°)	305 248 74	
Cable WM	Y-Cable 12p 1.9 m (M12f 90° DN – DE-9 and DC Jack Ø5.5/2.5 mm)	304 895 64	
ConBlock	Connection module	111 520 00	
ConBlock-X	Connection module IP66	303 740 66	
Draft Shield WKC205C	Draft Shield to place on WKC205C - Height: 51 mm	305 557 92	
Wind Ring WKC205C without holes	Wind Ring for WKC205C without holes (for applications without liquid handling)	305 557 89	

Order Information

Module	Item number
WKC205C	305 557 60

www.mt.com/APW

For more information



METTLER TOLEDO Group

Industrial Division

Local contact: www.mt.com/contacts

Subject to technical changes

© 03/2020 METTLER TOLEDO. All rights reserved

Document No. 30471357 A003

MarCom Industrial